

# Product leaflet

<b>Product</b>	<b>Model No.</b>	<b>Ordering No.</b>
Powered Air-Purifying Respirator (PAPR)	SR 500	H06-0121

## Product Description

The SR 500 system is a belt mounted Powered Air-Purifying Respirator (PAPR) with tight fitting face pieces, loose fitting respirators or loose fitting hoods that protects against particulates, gases and vapors, or a combination. It is designed to be used in oxygen sufficient and non-immediately dangerous to life and health (IDLH) environments. The SR 500 PAPR system functions as an alternative to Air Purifying Respirators (APR) in all situations for which these are recommended. This applies particularly to work that is hard, warm or of long-duration. The filtered air is supplied through a breathing hose to the tight fitting face piece, loose fitting respirators or loose fitting hoods. The above-atmospheric pressure then generated prevents pollutants from the surroundings from penetrating into the breathing zone.

### The characteristics of the SR 500 are as follows:

The battery is of lithium-ion type 3.5 Ah • Charging time around 2 hours • Equipped with two filters/combined filters • Operating time of up to 12 hours • The same control is used for starting, stopping and selection of operating status • Display with symbols • Equipped with automatic air flow control with compensation for air pressure and temperature • Can be used together with a hood, face shield, helmet, full face mask or half mask.

Electronics ingress protection is approved in IP class IP67 according to IEC / EN 60529.

## Technical specification

	SR 500	42 CFR part 84 Full facepiece	42 CFR part 84 Loose-fitting facepiece
<b>Air flow, min/max</b>	6.2 CFM (175 l/min)/8.5 CFM (240 l/min)	4.1 CFM (115 l/min)	6.0 CFM (170 l/min)
<b>Battery</b>	14.4 V, 3.5 Ah	-	-
<b>Operating times at 6.2 CFM / 8.0 CFM:</b>			
<b>P100 filter</b>	12 h/6 h	≥ 4 h	≥ 4 h
<b>Weight with P100 filter</b>	≈ 50 Ounce (1.400 g)	-	-
<b>Service temperature</b>	14 to 131 °F (-10 to +55 °C), < 90 % RH, 8.7 to 17.4 psi (600 to 1200 hPa)		- -
<b>Storage temperature</b>	4 to 104 °F (-20 to +40 °C), < 90 % RH		-
<b>Low flow warning level</b>	6.2 CFM (175 l/min)	-	-
<b>Protection factors<sup>1</sup>: SR 570</b>	25	-	-
<b>Protection factors<sup>2</sup>: SR 520, SR 530, SR 580, SR 580/SR 584, SR 601, SR 602</b>	1000	-	-
<b>Protection factors<sup>1</sup>: SR 200</b>	1000	-	-
<b>Protection factors<sup>1</sup>: SR 900</b>	50	-	-
<b>Approvals</b>	NIOSH 42 CFR part 84		-

1) Specified by OSHA and applies generally to all full facepieces and loose-fitting facepieces together with Powered Air-Purifying Respirator (PAPR) when the employer implements a continuing, effective respirator program as required by this section (29 CFR 1910.134)

2) APF (Assigned Protection Factor) documented in third party studies, according to OSHA 29 CFR 1910.134 and 3352-02-2009.



### Sundstrom Safety Inc.

143 Maple St.  
Warwick, RI 02888

Office: 1-401-434-7300  
Toll Free: 1-877-SUNDSTROM  
Fax: 1-401-434-8300

info@srsafety.com  
www.srsafety.com

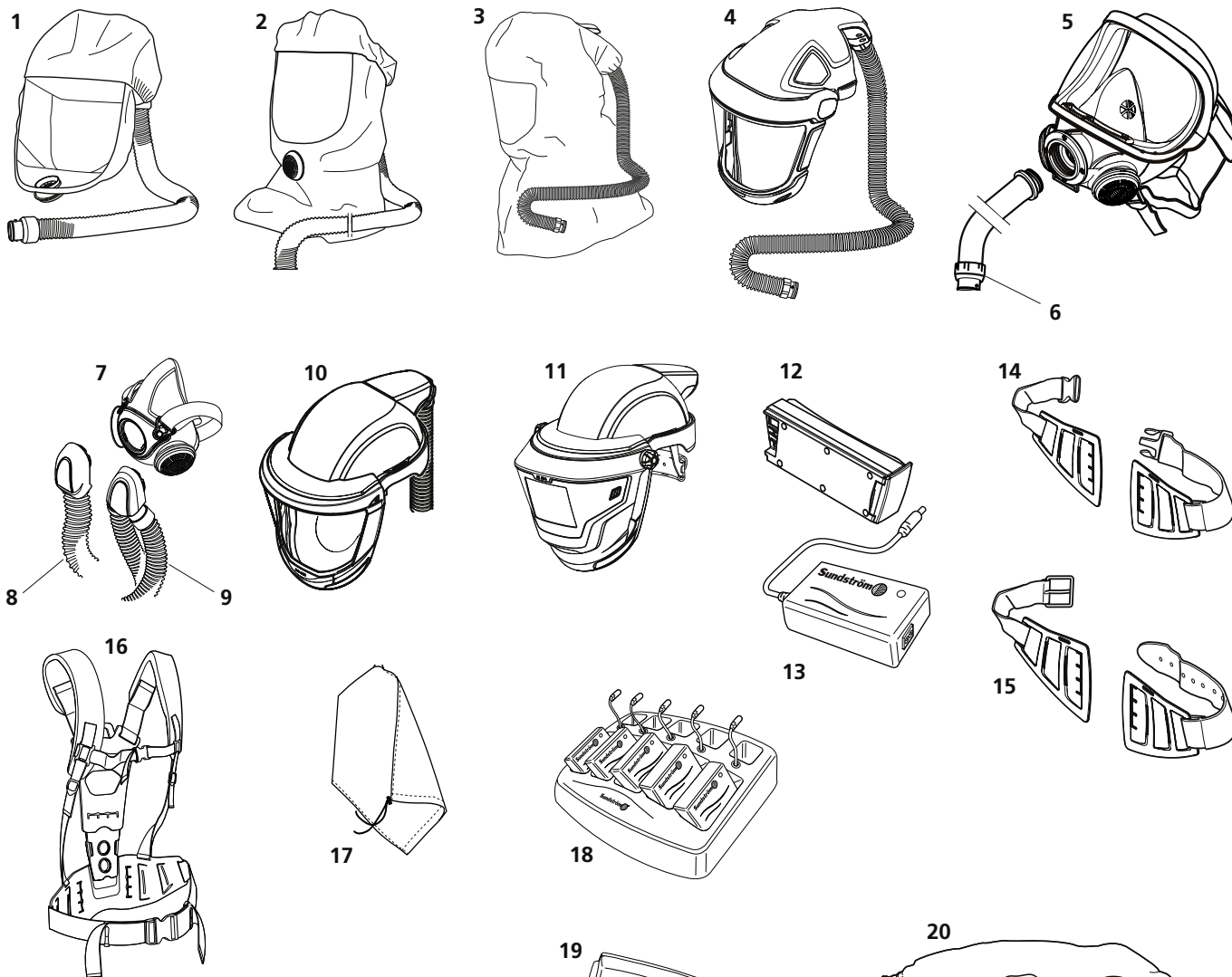

### Head-tops, spare parts and accessories

#### Item

No.	Part	Ordering No.
1.	Hood SR 520 M/L	H06-0221
1.	Hood SR 520 S/M	H06-0321
2.	Hood SR 530	H06-0421
3.	Hood SR 601	H06-5421
3.	Hood SR 602	H06-5521
4.	Face shield SR 570	H06-6521
5.	Full face mask SR 200, PC visor	H01-1221
5.	Full face mask SR 200, glass visor	H01-1321
6.	PU hose SR 550 for SR 200	T01-1216
6.	Rubber hose SR 551 for SR 200	T01-1218
7.	Half mask SR 900 S	H01-3021
7.	Half mask SR 900 M	H01-3121
7.	Half mask SR 900 L	H01-3221
8.	Hose SR 951	T01-3010
9.	Twin hose SR 952	R01-3013
10.	Helmet with visor SR 580	H06-8021
11.	Welding shield/Helmet with visor SR 584/SR 580	H06-8310
12.	Battery HD SR 502, 3.5 Ah	T06-0101
13.	Battery charger SR 513	R06-0103
14.	Belt SR 508	R06-0101
14.	Rubber belt	T06-0104
15.	Leather belt	T06-0103
16.	Harness SR 552	T06-0116
17.	Flow meter SR 356	R03-0346
18.	Charging station without chargers SR 506	T06-0108
18.	Charging station, complete SR 516	T06-0111
19.	PAPR SR 500, bare	R06-0121
20.	Splash cover SR 514	T06-0114
21.	Storage bag SR 505 w two compartments	T06-0102
22.	Pre-filter holder SR 512	R06-0106
23.	Particulate filter P100/HE, SR 510	H02-1321
24.	Filter adapter SR 511	R06-0105
25.	Pre-filter holder	R01-0605
26.	Particulate filter HE, SR 710	H02-1521
27.	Chemical cartridge SR 532 OV/SD/CL/HC/HF	H02-7121
28.	Chemical cartridge SR 533 CL/HC/SD/FM/AM/MA	H02-7221
29.	Gasket for PAPR	R06-0107
30.	Plug kit	R06-0703

